

AVAILABLE VOLTAGES: 24, 90 VDC
 RATED TORQUE: 15 LB-IN
 MAX. DRAG TORQUE: 0.4 LB-IN
 MAX. HEAT DISSIPATION: 20 WATTS

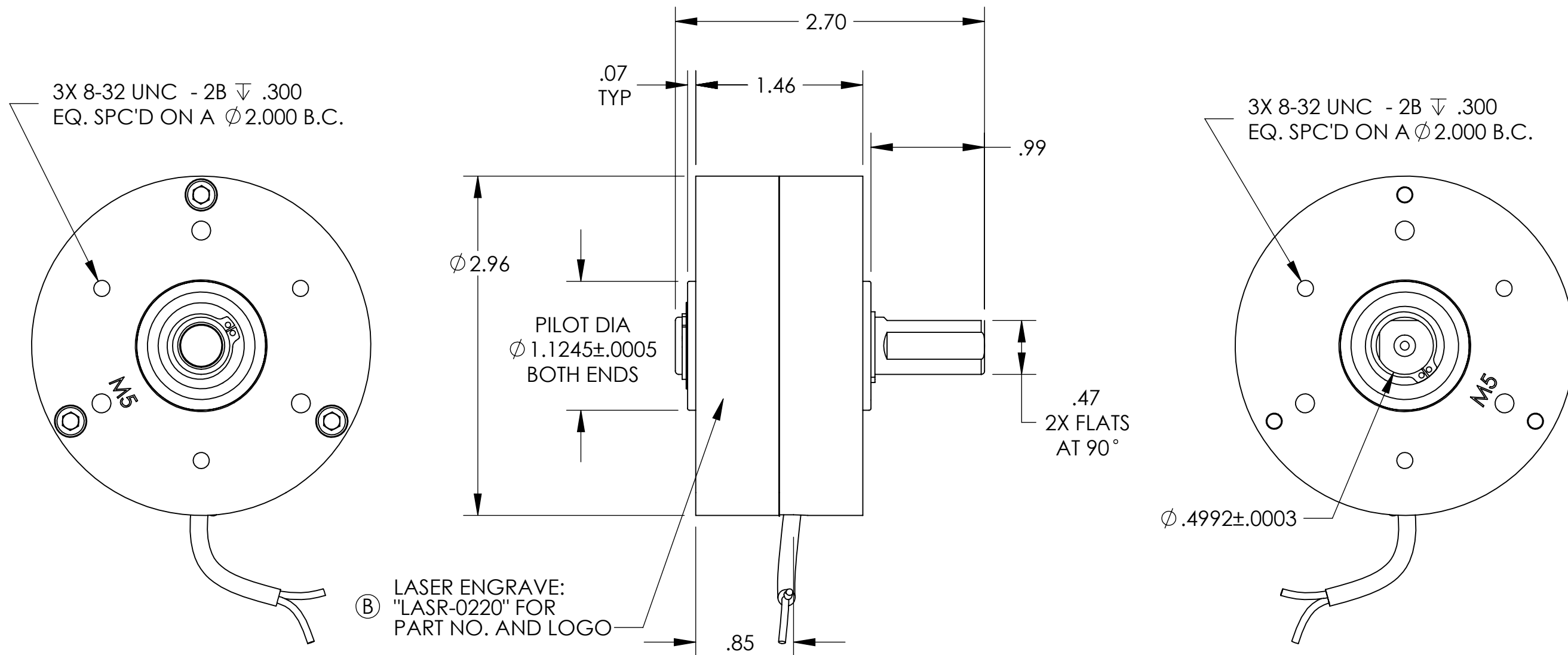

REV.	DESCRIPTION	DATE	NUMBER
B	REPLACE STICKER LABEL WITH LASER ENGRAVE	1/5/2023	2408
A	INITIAL RELEASE IN SOLIDWORKS	5/20/2005	163

PROPRIETARY AND CONFIDENTIAL
 THE INFORMATION CONTAINED IN THIS DRAWING IS THE SOLE PROPERTY OF PRECISION TORQUE CONTROL. ANY REPRODUCTION IN PART OR AS A WHOLE WITHOUT THE WRITTEN PERMISSION OF PRECISION TORQUE CONTROL IS PROHIBITED.

UNLESS OTHERWISE SPECIFIED:
 DIMENSIONS ARE IN INCHES.
 ALL DIMENSIONS ARE PRE-FINISH.
 REMOVE ALL SHARP EDGES .005/.015

TOLERANCES:
 ANGULAR = \pm 0.5°
 TWO PLACE DECIMAL = \pm 0.015
 THREE PLACE DECIMAL = \pm 0.010

ALL MACHINED SURFACES TO BE:
 PERPENDICULAR, CONCENTRIC,
 PARALLEL WITHIN 0.005 TIR

DO NOT SCALE DRAWING

	NAME	DATE
DRAWN	JHE	05-20-05
ENG APPR.	MSCOTT	09-28-05
DENSITY:	lbs/cu in	
WEIGHT:	2.72 lbs	
INERTIA:	lbs sq in	
MATERIAL	STEEL	
FINISH	YELLOW DICHROMATE	

PRECISION TORQUE CONTROL Midland, MI U.S.A.		
TITLE: ASSEMBLY		
SIZE B	DWG. NO. MPB15-3	REV B
SCALE: 1:1	DATE OF PRINT: 1/5/2023	

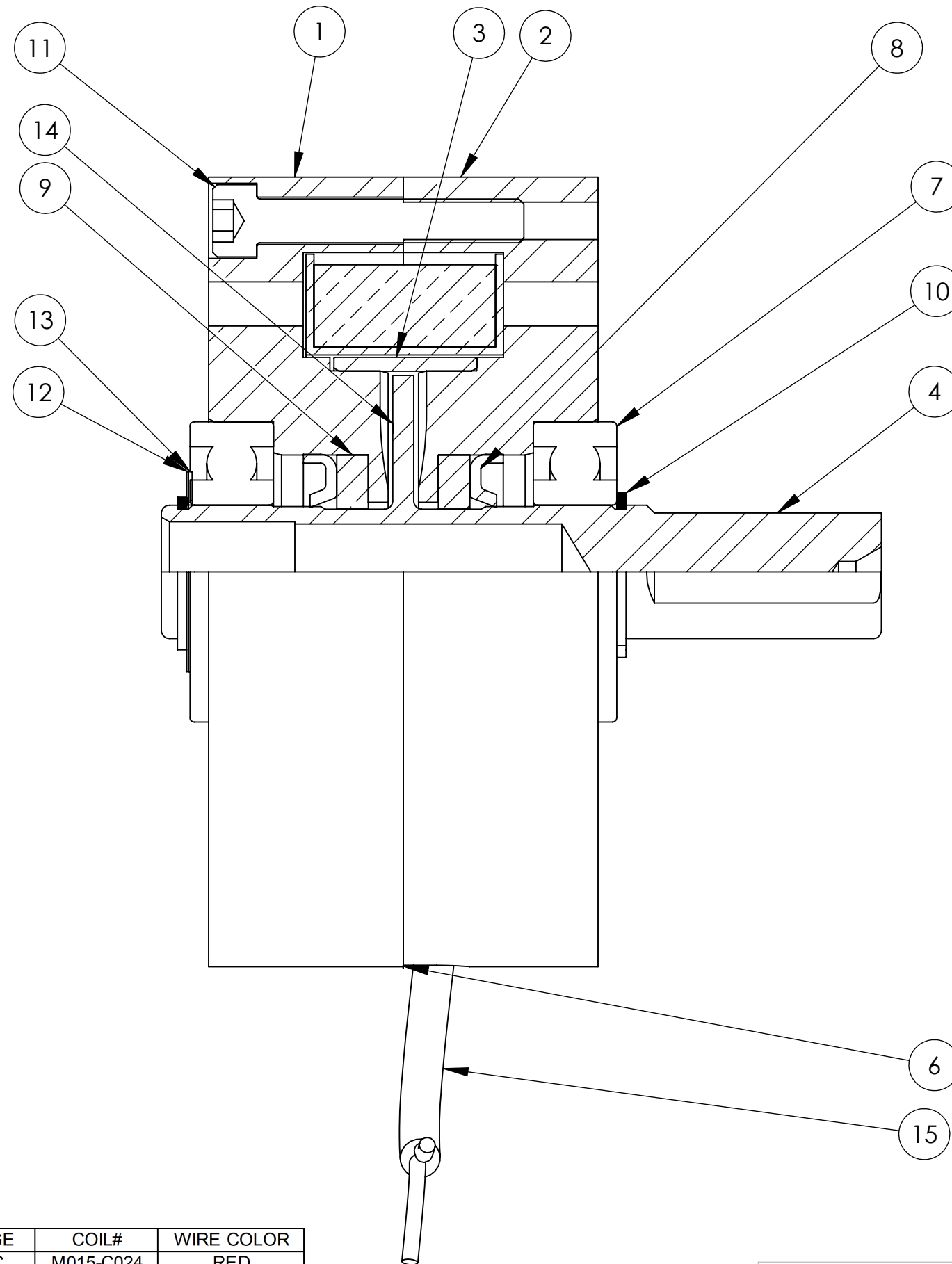

NO.	PART NO.	DESCRIPTION	QTY.
1	M015-3001	END CAP	1
2	M015-3002	END CAP	1
3	M015-5001	SPACER	1
4	M015-R001	ROTOR	1
5	SEE CHART	COIL	1
6	YAD1-0006	3M HOT MELT	1
7	YBAB-0006	BEARING SEAL	2
8	YLS1-0002	GREASE SEAL	2
9	YLS2-0002	FELT SEAL	2
10	YRS2-0005	EXT RET RING	2
11	YSC1-0012	SHCS 8-32 X 1 SS	3
12	YWS1-0007	SHIM	1
13	YWS1-0008	SHIM	1
14	YZ00-0015	MAGNETIC POWDER	1
15	YZ00-0021	SHRINK TUBE	1

MODEL	VOLTAGE	COIL#	WIRE COLOR
MPC15-3-24	24 VDC	M015-C024	RED
MPC15-3-90	90 VDC	M015-C090	BLACK

PROPRIETARY AND CONFIDENTIAL
 THE INFORMATION CONTAINED IN THIS DRAWING IS THE SOLE PROPERTY OF PRECISION TORQUE CONTROL. ANY REPRODUCTION IN PART OR AS A WHOLE WITHOUT THE WRITTEN PERMISSION OF PRECISION TORQUE CONTROL IS PROHIBITED.

UNLESS OTHERWISE SPECIFIED:
 DIMENSIONS ARE IN INCHES.
 ALL DIMENSIONS ARE PRE-FINISH.
 REMOVE ALL SHARP EDGES .005/.015

TOLERANCES:
 ANGULAR = ±0.5°
 TWO PLACE DECIMAL = ±0.015
 THREE PLACE DECIMAL = ±0.010

ALL MACHINED SURFACES TO BE:
 PERPENDICULAR, CONCENTRIC,
 PARALLEL WITHIN 0.005 TIR

DO NOT SCALE DRAWING

	NAME	DATE
DRAWN	JHE	05-20-05
ENG APPR.	MSCOTT	09-28-05
DENSITY:	lbs/cu in	
WEIGHT:	2.72 lbs	
INERTIA:	lbs sq in	
MATERIAL	STEEL	
FINISH	YELLOW DICHROMATE	

PRECISION TORQUE CONTROL
 Midland, MI U.S.A.

TITLE:
ASSEMBLY

SIZE	DWG. NO.	REV
B	MPB15-3	B

SCALE: 2:1 DATE OF PRINT: 1/5/2023