

AVAILABLE VOLTAGES: 24, 90 VDC
 RATED TORQUE: 240 LB-IN
 DRAG TORQUE:
 MAX. HEAT DISSIPATION: 200 WATTS

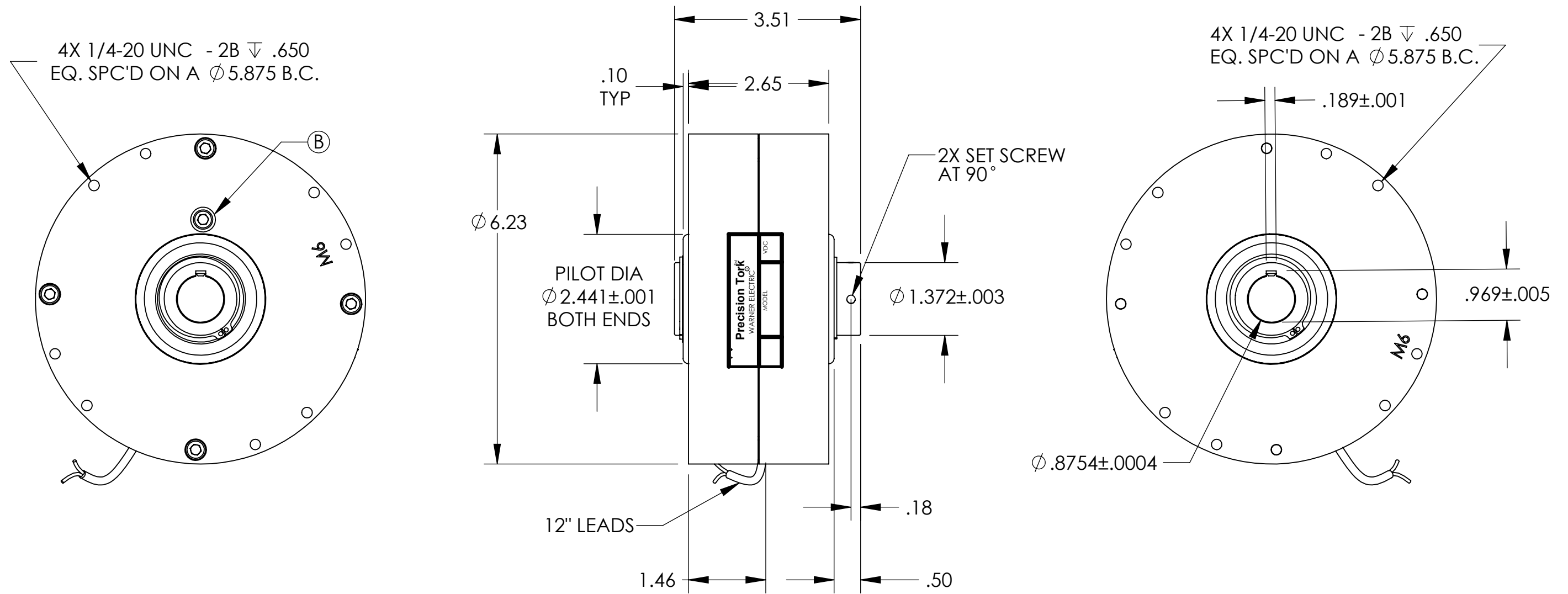

REV.	DESCRIPTION	DATE	NUMBER
B	UPDATED FILLER CAP	2/24/2010	769
A	INITIAL RELEASE IN SOLIDWORKS	8/18/2005	163

PROPRIETARY AND CONFIDENTIAL
 THE INFORMATION CONTAINED IN THIS DRAWING IS THE SOLE PROPERTY OF PRECISION TORQUE CONTROL. ANY REPRODUCTION IN PART OR AS A WHOLE WITHOUT THE WRITTEN PERMISSION OF PRECISION TORQUE CONTROL IS PROHIBITED.

UNLESS OTHERWISE SPECIFIED:
 DIMENSIONS ARE IN INCHES.
 ALL DIMENSIONS ARE PRE-FINISH.
 REMOVE ALL SHARP EDGES .005/.015

TOLERANCES:
 ANGULAR = \pm 0.5°
 TWO PLACE DECIMAL = \pm 0.015
 THREE PLACE DECIMAL = \pm 0.010

ALL MACHINED SURFACES TO BE:
 PERPENDICULAR, CONCENTRIC,
 PARALLEL WITHIN 0.005 TIR

DO NOT SCALE DRAWING

	NAME	DATE
DRAWN	JHE	08-18-05
ENG APPR.	MSCOTT	08-18-05
DENSITY:	lbs/cu in	
WEIGHT:	21.23 lbs	
INERTIA:	lbs sq in	
MATERIAL	STEEL	
FINISH	YELLOW DICHROMATE	

PRECISION TORQUE CONTROL Midland, MI U.S.A.		
TITLE: ASSEMBLY		
SIZE B	DWG. NO. MPB240-2	REV B
SCALE: 1:2	DATE OF PRINT: 2/24/2010	

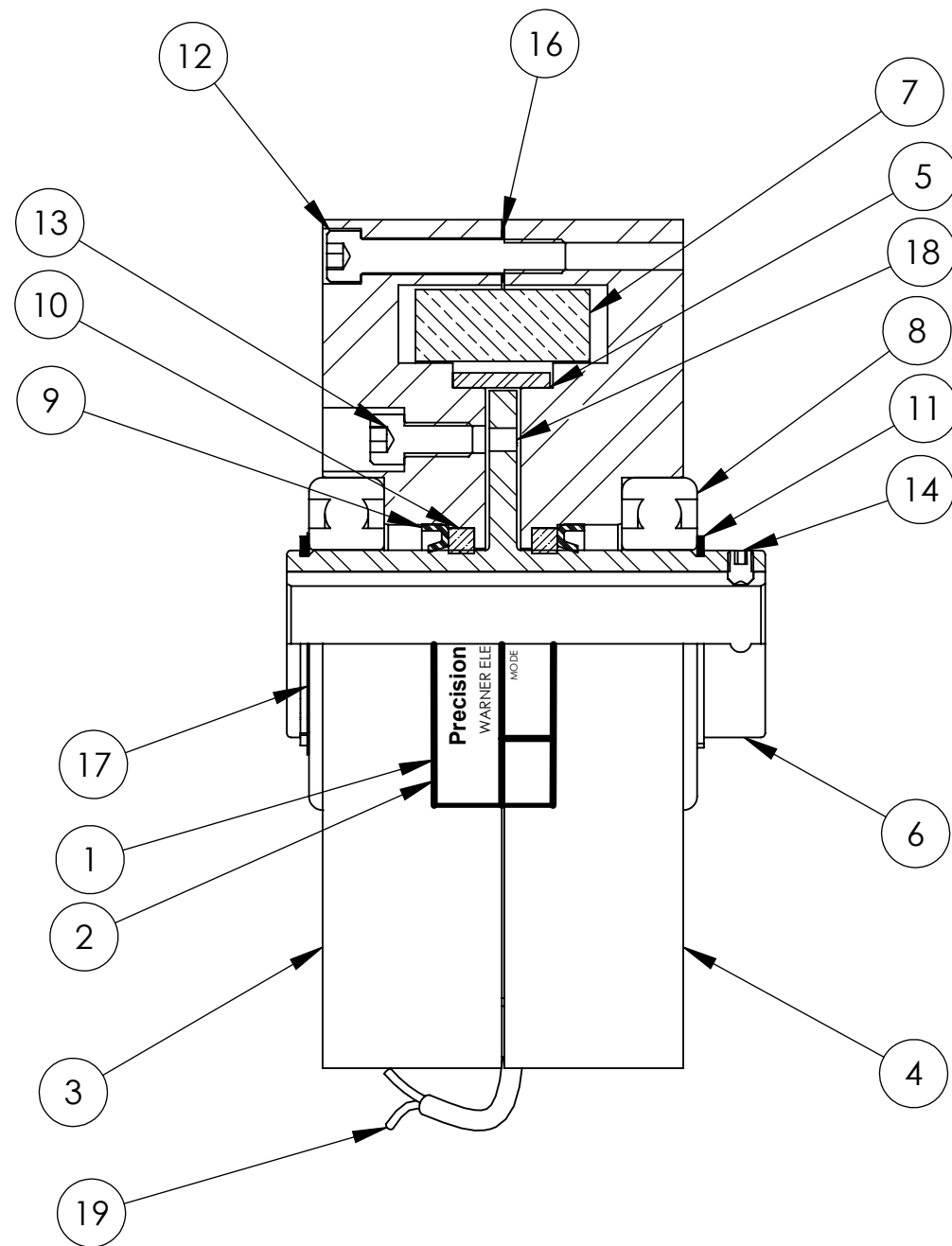

NO.	PART NO.	DESCRIPTION	QTY.
1	M099-9001	LABEL-MODEL#	1
2	M099-9003	LABEL-OVERLAY	1
3	M240-3001	END CAP	1
4	M240-3002	END CAP	1
5	M240-5001	SPACER	1
6	M240-R001	ROTOR	1
7	SEE CHART	COIL	1
8	YBAB-0003	BEARING SEAL	2
9	YLS1-0004	GREASE SEAL	2
10	YLS2-0004	FELT SEAL	2
11	YRS2-0007	EXT RET RING	2
12	YSC1-0016	SHCS 1/4-20 x 1 1/2 SS	4
13	YSC1-0020	SHCS 1/4-20 X 1/2 SS	1
14	YSS1-0003	SS 10-32 X 1/4 SS CUP PNT	1
15	YWS1-0004	SHIM	1
16	YWS1-0014	SHIM	4
17	YWS1-0017	SHIM	1
18	YZ00-0015	MAGNETIC POWDER	-
19	YZ00-0021	SHRINK TUBE	1

MODEL	VOLTAGE	COIL#	WIRE COLOR
MPB240-2-24	24 VDC	M240-C024	RED
MPB240-2-90	90 VDC	M240-C090	BLACK

PROPRIETARY AND CONFIDENTIAL
 THE INFORMATION CONTAINED IN THIS DRAWING IS THE SOLE PROPERTY OF PRECISION TORQUE CONTROL. ANY REPRODUCTION IN PART OR AS A WHOLE WITHOUT THE WRITTEN PERMISSION OF PRECISION TORQUE CONTROL IS PROHIBITED.

UNLESS OTHERWISE SPECIFIED:
 DIMENSIONS ARE IN INCHES.
 ALL DIMENSIONS ARE PRE-FINISH.
 REMOVE ALL SHARP EDGES .005/.015
 TOLERANCES:
 ANGULAR = ±0.5°
 TWO PLACE DECIMAL = ±0.015
 THREE PLACE DECIMAL = ±0.010
 ALL MACHINED SURFACES TO BE:
 PERPENDICULAR, CONCENTRIC,
 PARALLEL WITHIN 0.005 TIR
 DO NOT SCALE DRAWING

	NAME	DATE
DRAWN	JHE	08-18-05
ENG APPR.	MSCOTT	08-18-05
DENSITY:	lbs/cu in	
WEIGHT:	21.23 lbs	
INERTIA:	lbs sq in	
MATERIAL	STEEL	
FINISH	YELLOW DICHROMATE	

PRECISION TORQUE CONTROL
Midland, MI U.S.A.

TITLE:
ASSEMBLY

SIZE	DWG. NO.	REV
B	MPB240-2	B
SCALE: 3:4	DATE OF PRINT: 2/24/2010	