

VOLTAGE: 24, 90 VDC
 RATED TORQUE: 15 LB-IN
 MAX. DRAG TORQUE: 0.4 LB-IN
 MAX. HEAT DISSIPATION: 20 WATTS

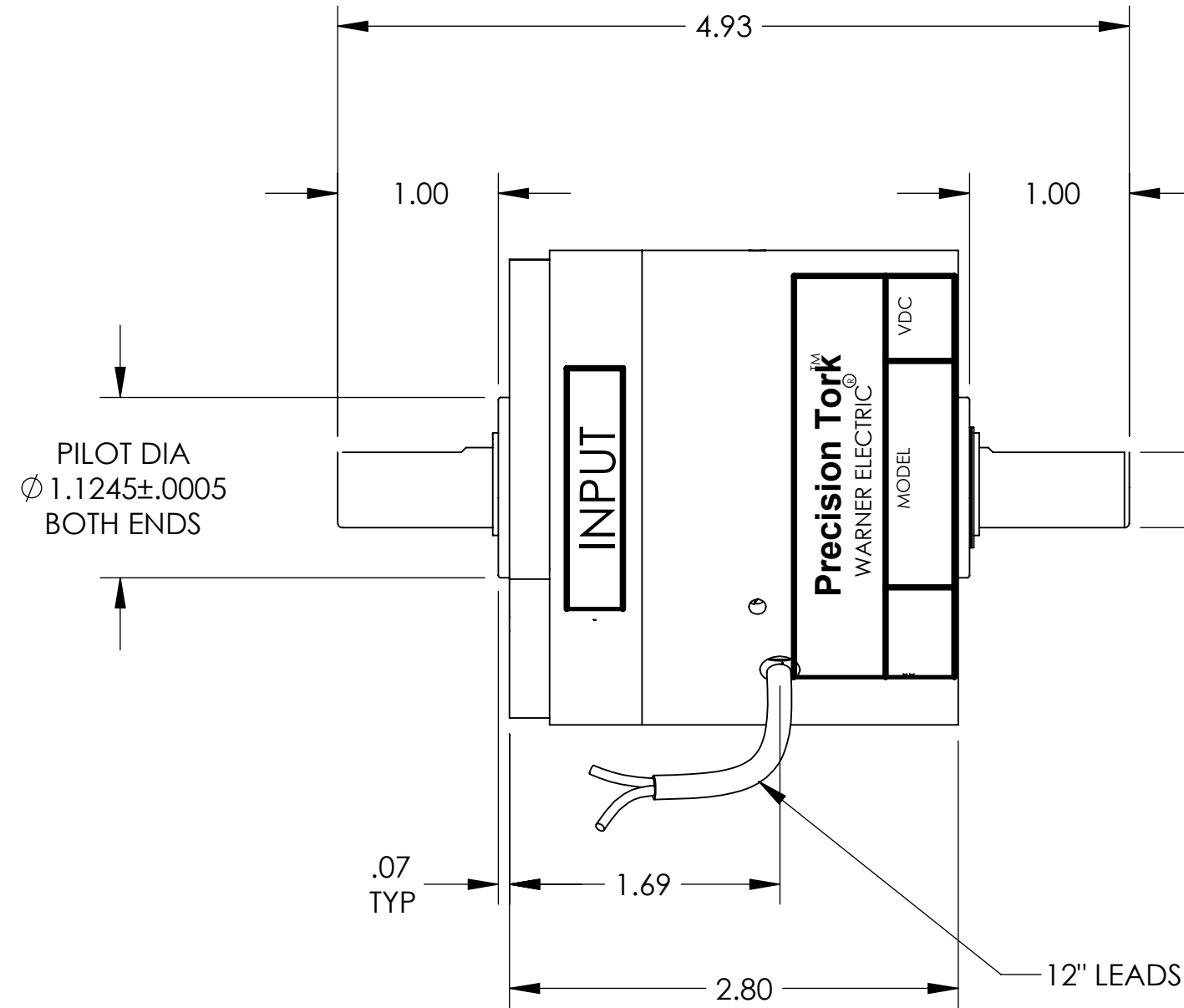

.47
 2X FLATS
 AT 90°
 BOTH ENDS

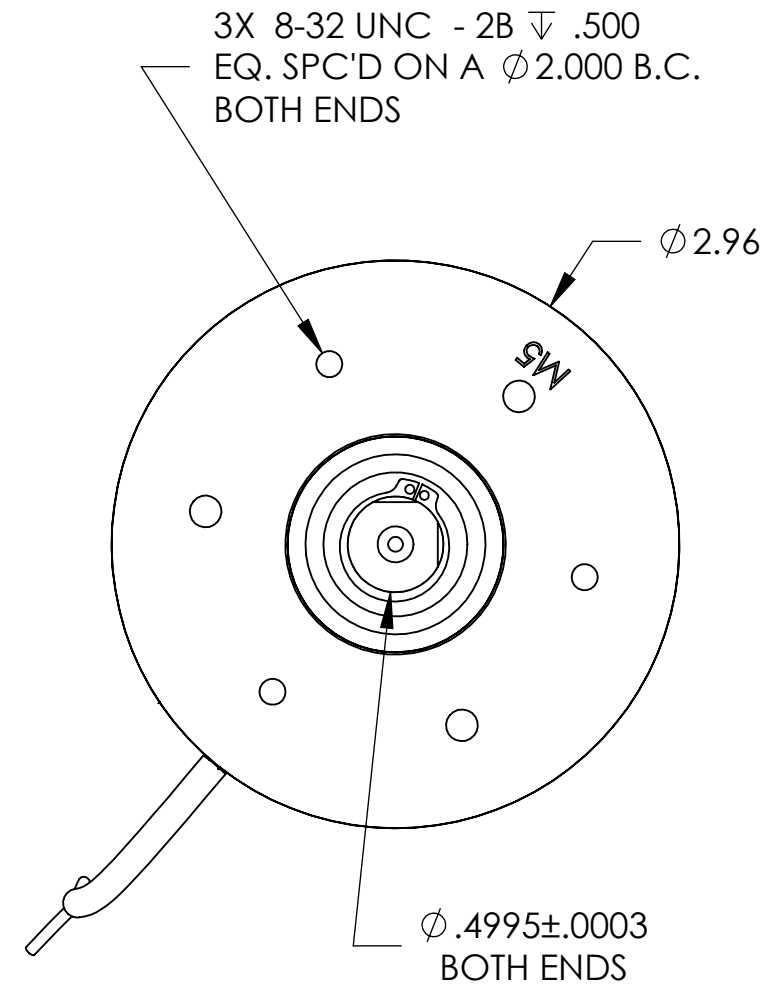

UNLESS OTHERWISE SPECIFIED:		NAME	DATE
DIMENSIONS ARE IN INCHES. ALL DIMENSIONS ARE PRE-FINISH. REMOVE ALL SHARP EDGES .005/.015		DRAWN JHE	06-07--05
TOLERANCES: ANGULAR = ±0.5° TWO PLACE DECIMAL = ±0.015 THREE PLACE DECIMAL = ±0.010		ENG APPR. MSCOTT	09-28-05
ALL MACHINED SURFACES TO BE: PERPENDICULAR, CONCENTRIC, PARALLEL WITHIN 0.005 TIR		DENSITY:	lbs/cu in
		WEIGHT:	5.08 lbs
		INERTIA:	lbs sq in
		MATERIAL	STEEL
		FINISH	YELLOW DICHROMATE

PRECISION TORQUE CONTROL Midland, MI U.S.A.		
TITLE: ASSEMBLY		
SIZE B	DWG. NO. MPC15-1	REV A
SCALE: 1:1	DATE OF PRINT: 11/11/2010	

PROPRIETARY AND CONFIDENTIAL
 THE INFORMATION CONTAINED IN THIS DRAWING IS THE SOLE PROPERTY OF PRECISION TORQUE CONTROL. ANY REPRODUCTION IN PART OR AS A WHOLE WITHOUT THE WRITTEN PERMISSION OF PRECISION TORQUE CONTROL IS PROHIBITED.

REV.	DESCRIPTION	DATE	NUMBER
A	INITIAL RELEASE IN SOLIDWORKS	8/22/2005	163

DO NOT SCALE DRAWING

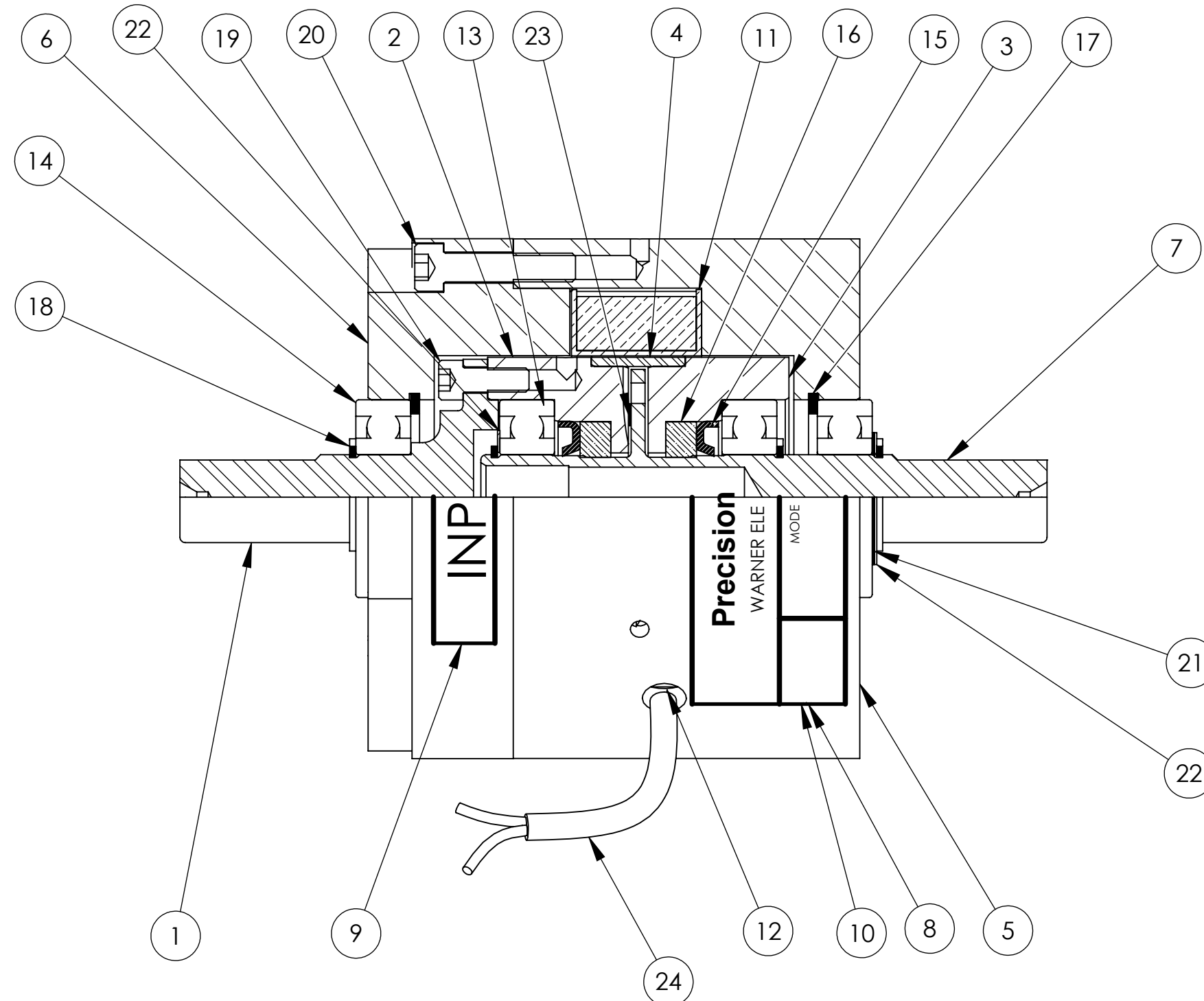

NO.	PART NO.	DESCRIPTION	QTY.
1	M015-2101	INPUT SHAFT	1
2	M015-3003	END CAP	1
3	M015-3004	END CAP	1
4	M015-5001	SPACER	1
5	M015-6001	OUTPUT HOUSING	1
6	M015-6002	INPUT HOUSING	1
7	M015-R002	ROTOR	1
8	M099-9001	LABEL-MODEL#	1
9	M099-9002	LABEL-INPUT	1
10	M099-9003	LABEL-OVERLAY	1
11	SEE CHART	COIL	1
12	YAD1-0006	3M HOT MELT	1
13	YBAB-0006	BEARING SEAL	2
14	YBAB-0007	BEARING SHIELD	2
15	YLS1-0002	GREASE SEAL	2
16	YLS2-0002	FELT SEAL	2
17	YRS1-0005	INT RET RING	2
18	YRS2-0005	EXT RET RING	4
19	YSC1-0008	SHCS 6-32 X 3/8 SS	3
20	YSC1-0033	SHCS 8-32 X 3/4 SS	3
21	YWS1-0007	SHIM	2
22	YWS1-0008	SHIM	2
23	YZ00-0015	MAGNETIC POWDER	1
24	YZ00-0021	SHRINK TUBE	1

MODEL	VOLTAGE	COIL#	WIRE COLOR
MPC15-1-24	24 VDC	M015-C024	RED
MPC15-1-90	90 VDC	M015-C090	BLACK

PROPRIETARY AND CONFIDENTIAL
 THE INFORMATION CONTAINED IN THIS DRAWING IS THE SOLE PROPERTY OF PRECISION TORQUE CONTROL. ANY REPRODUCTION IN PART OR AS A WHOLE WITHOUT THE WRITTEN PERMISSION OF PRECISION TORQUE CONTROL IS PROHIBITED.

UNLESS OTHERWISE SPECIFIED:		NAME	DATE
DIMENSIONS ARE IN INCHES. ALL DIMENSIONS ARE PRE-FINISH. REMOVE ALL SHARP EDGES .005/.015		JHE	06-07--05
TOLERANCES: ANGULAR = ±0.5° TWO PLACE DECIMAL = ±0.015 THREE PLACE DECIMAL = ±0.010		MSCOTT	09-28-05
ALL MACHINED SURFACES TO BE: PERPENDICULAR, CONCENTRIC, PARALLEL WITHIN 0.005 TIR		DENSITY:	lbs/cu in
DO NOT SCALE DRAWING		WEIGHT:	5.08 lbs
		INERTIA:	lbs sq in
		MATERIAL:	STEEL
		FINISH:	YELLOW DICHROMATE

PRECISION TORQUE CONTROL
Midland, MI U.S.A.

TITLE:
ASSEMBLY

SIZE	DWG. NO.	REV
B	MPC15-1	A

SCALE: 4:3 DATE OF PRINT: 11/11/2010