

AVAILABLE VOLTAGES: 24, 90 VDC  
 RATED TORQUE: 2 LB-IN  
 MAX. DRAG TORQUE: 0.4 LB-IN  
 MAX. HEAT DISSIPATION: 10 WATTS

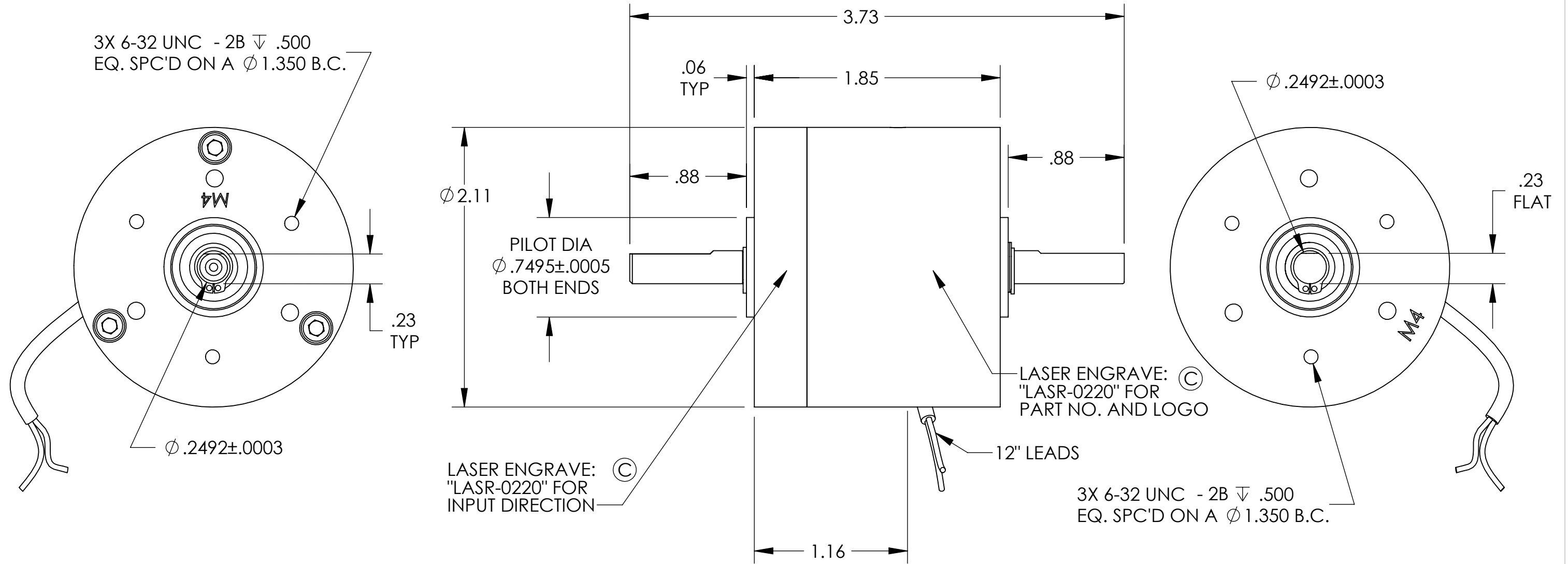

REV.	DESCRIPTION	DATE	NUMBER
C	REPLACED STICKERS WITH LASER ENGRAVE	7/25/2023	2408
B	REPLACE GREASE SEAL WITH FELT SEAL	6/17/2009	678
A	INITIAL RELEASE IN SOLIDWORKS	5/6/2005	163

**PROPRIETARY AND CONFIDENTIAL**  
 THE INFORMATION CONTAINED IN THIS DRAWING IS THE SOLE PROPERTY OF PRECISION TORQUE CONTROL. ANY REPRODUCTION IN PART OR AS A WHOLE WITHOUT THE WRITTEN PERMISSION OF PRECISION TORQUE CONTROL IS PROHIBITED.

UNLESS OTHERWISE SPECIFIED:		NAME	DATE
DIMENSIONS ARE IN INCHES. ALL DIMENSIONS ARE PRE-FINISH. REMOVE ALL SHARP EDGES .005/.015		JHE	05-05-05
TOLERANCES: ANGULAR = $\pm$ 0.5° TWO PLACE DECIMAL = $\pm$ 0.015 THREE PLACE DECIMAL = $\pm$ 0.010		MSCOTT	12-05-05
ALL MACHINED SURFACES TO BE: PERPENDICULAR, CONCENTRIC, PARALLEL WITHIN 0.005 TIR		DENSITY:	lbs/cu in
DO NOT SCALE DRAWING		WEIGHT:	1.69 lbs
		INERTIA:	lbs sq in
		MATERIAL:	STEEL
		FINISH:	YELLOW DICHROMATE

PRECISION TORQUE CONTROL Midland, MI U.S.A.		
TITLE: <b>ASSEMBLY</b>		
SIZE <b>B</b>	DWG. NO. <b>MPC2-1</b>	REV <b>C</b>
SCALE: 4:3	DATE OF PRINT: 7/25/2023	

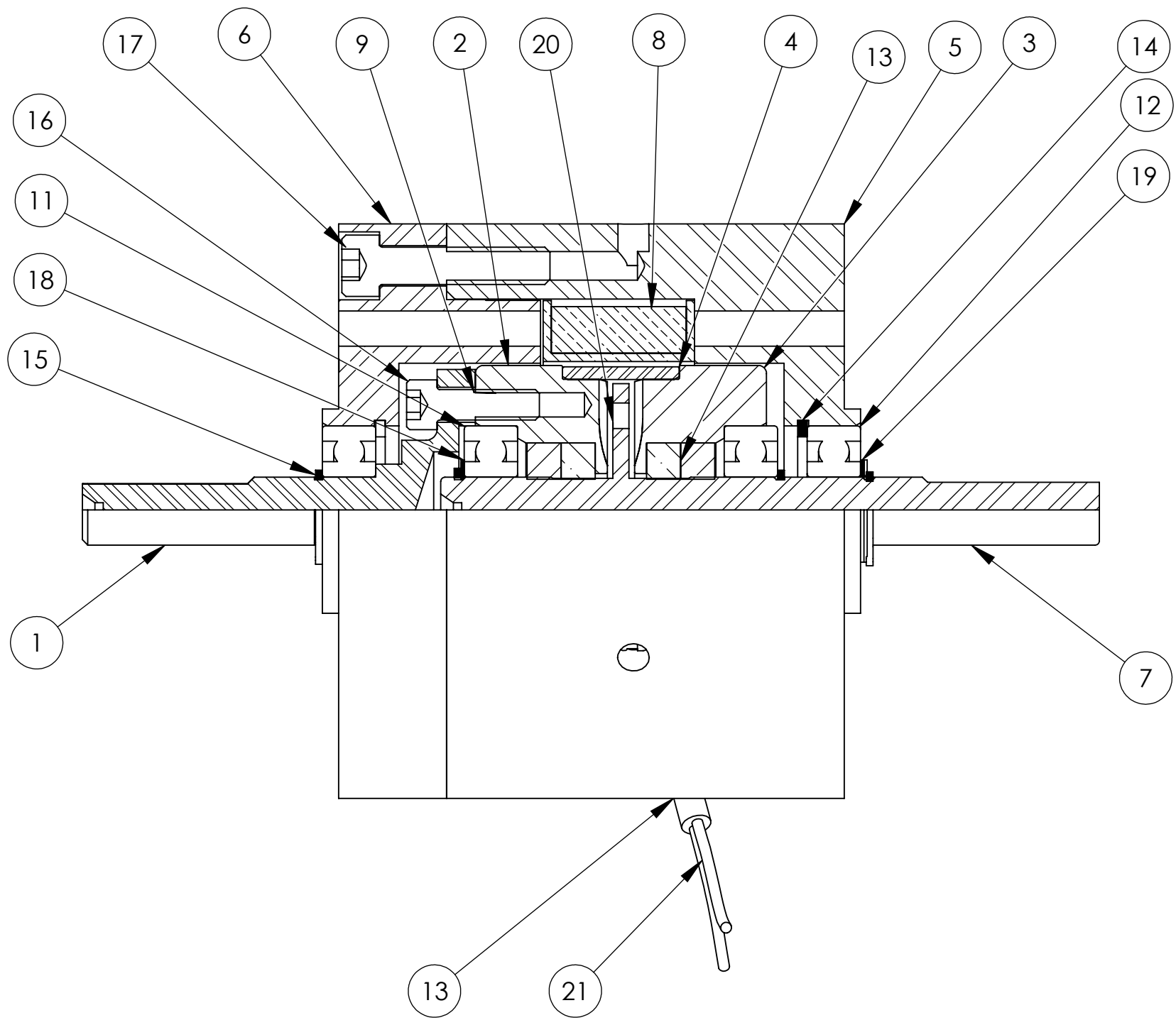

NO.	PART NO.	DESCRIPTION	QTY.
1	M002-2101	INPUT SHAFT	1
2	M002-3003	END CAP	1
3	M002-3004	END CAP	1
4	M002-5001	SPACER	1
5	M002-6001	HOUSING	1
6	M002-6002	HOUSING	1
7	M002-R002	ROTOR	1
8	SEE CHART	COIL	1
9	YAD1-0005	242 BLUE THREADLOCKER	1
10	YAD1-0006	3M HOT MELT	1
11	YBAB-0008	BEARING SEAL	2
12	YBAB-0009	BEARING SHIELD	2
13	YLS2-0001	FELT SEAL	4
14	YRS1-0004	INT RET RING	2
15	YRS2-0002	EXT RET RING	4
16	YSC1-0017	SHCS 4-40 X 3/8 SS	3
17	YSC1-0018	SHCS 6-32 X 5/8 SS	3
18	YWS1-0004	SHIM	2
19	YWS1-0005	SHIM	2
20	YZ00-0015	MAGNETIC POWDER	1
21	YZ00-0021	SHRINK TUBE	1

MODEL	VOLTAGE	COIL#	WIRE COLOR
MPC2-1-24	24 VDC	M002-C024	RED
MPC2-1-90	90 VDC	M002-C090	BLACK

**PROPRIETARY AND CONFIDENTIAL**  
 THE INFORMATION CONTAINED IN THIS DRAWING IS THE SOLE PROPERTY OF PRECISION TORQUE CONTROL. ANY REPRODUCTION IN PART OR AS A WHOLE WITHOUT THE WRITTEN PERMISSION OF PRECISION TORQUE CONTROL IS PROHIBITED.

UNLESS OTHERWISE SPECIFIED:		NAME	DATE
DIMENSIONS ARE IN INCHES. ALL DIMENSIONS ARE PRE-FINISH. REMOVE ALL SHARP EDGES .005/.015		DRAWN JHE	05-05-05
TOLERANCES: ANGULAR = ±0.5° TWO PLACE DECIMAL = ±0.015 THREE PLACE DECIMAL = ±0.010		ENG APPR. MSCOTT	12-05-05
ALL MACHINED SURFACES TO BE: PERPENDICULAR, CONCENTRIC, PARALLEL WITHIN 0.005 TIR		DENSITY: lbs/cu in	
DO NOT SCALE DRAWING		WEIGHT: 1.69 lbs	
		INERTIA: lbs sq in	
		MATERIAL STEEL	
		FINISH YELLOW DICHROMATE	

**PRECISION TORQUE CONTROL**  
 Midland, MI U.S.A.

TITLE:  
**ASSEMBLY**

SIZE <b>B</b>	DWG. NO. <b>MPC2-1</b>	REV <b>C</b>
SCALE: 2:1	DATE OF PRINT: 7/25/2023	