

VOLTAGE: 90 VDC
 ROTED TORQUE: 35 LB-IN
 MAX. HEAT DISSIPATION: 100 WATTS

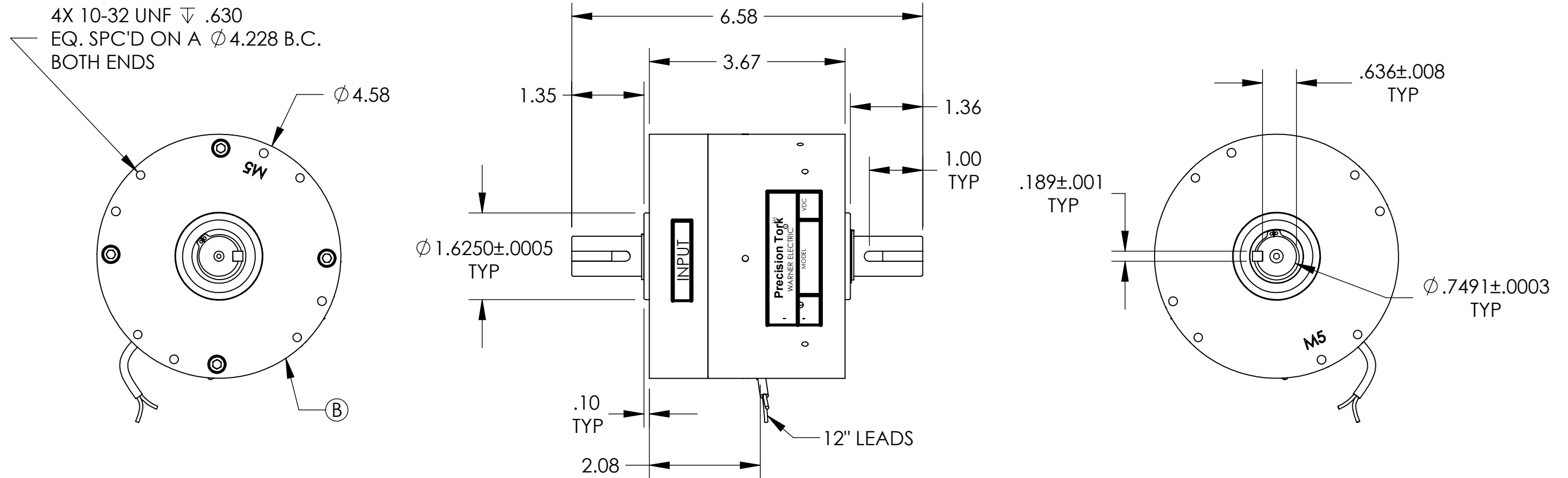

REV.	DESCRIPTION	DATE	NUMBER
B	UPDATED HOUSINGS	7/23/2012	1211
A	INITIAL RELEASE IN SOLIDWORKS	6/3/2010	163

PROPRIETARY AND CONFIDENTIAL
 THE INFORMATION CONTAINED IN THIS DRAWING IS THE SOLE PROPERTY OF PRECISION TORQUE CONTROL. ANY REPRODUCTION IN PART OR AS A WHOLE WITHOUT THE WRITTEN PERMISSION OF PRECISION TORQUE CONTROL IS PROHIBITED.

UNLESS OTHERWISE SPECIFIED:		NAME	DATE	PRECISION TORQUE CONTROL Midland, MI U.S.A.
DIMENSIONS ARE IN INCHES. ALL DIMENSIONS ARE PRE-FINISH. REMOVE ALL SHARP EDGES .005/.015		DRAWN	JHE 06-03-10	
TOLERANCES: ANGULAR = \pm 0.5° TWO PLACE DECIMAL = \pm 0.015 THREE PLACE DECIMAL = \pm 0.010		ENG APPR.	MSCOTT 06-03-10	
ALL MACHINED SURFACES TO BE: PERPENDICULAR, CONCENTRIC, PARALLEL WITHIN 0.005 TIR		DENSITY:	lbs/cu in	SIZE
DO NOT SCALE DRAWING		WEIGHT:	16.040 lbs	B
		INERTIA:	lbs sq in	DWG. NO.
		MATERIAL		MPC70-001
		FINISH		REV
				B
		SCALE: 1:2	DATE OF PRINT: 7/23/2012	

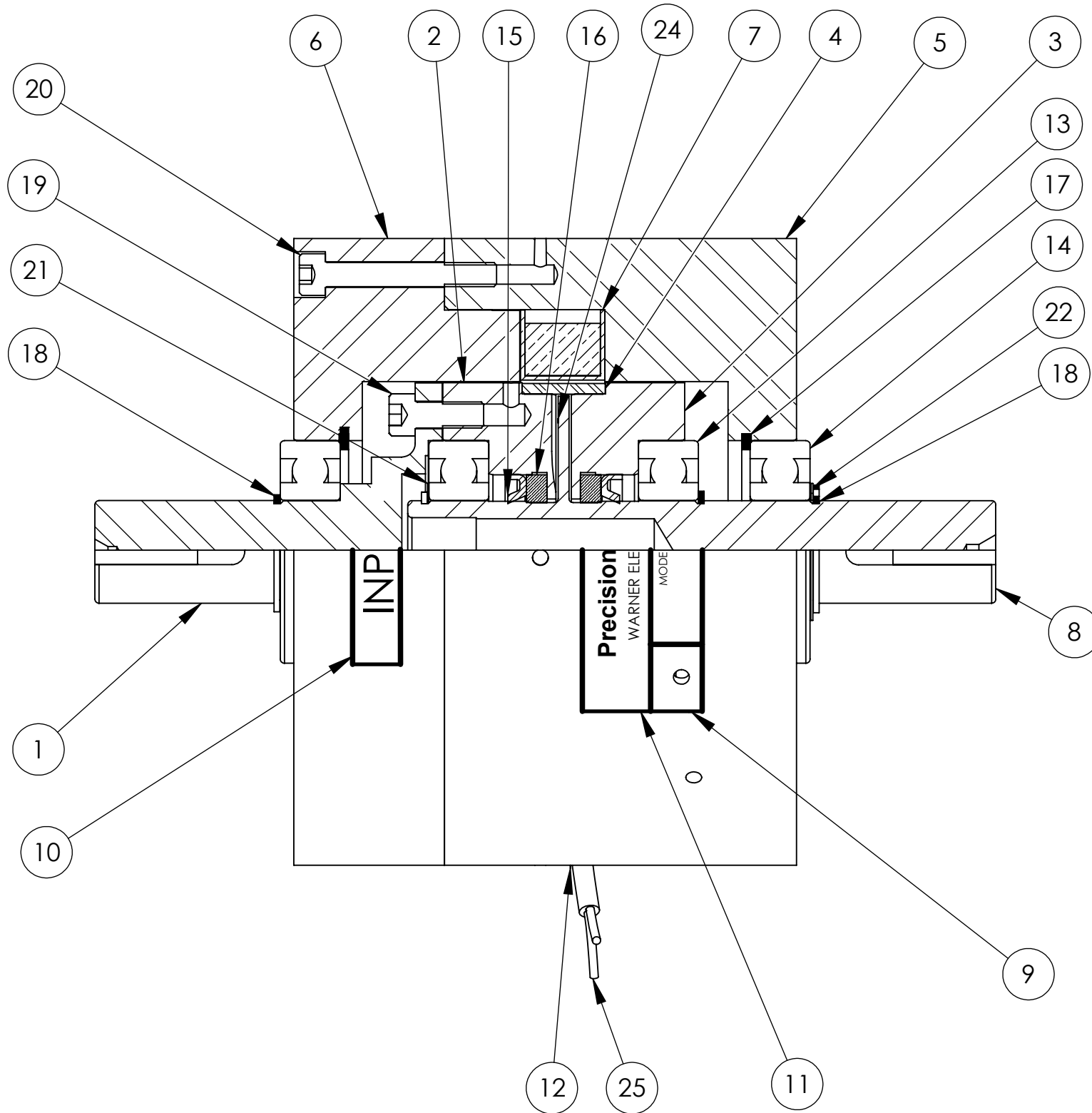

NO.	PART NO.	DESCRIPTION	QTY.
1	M070-2101	INPUT SHAFT	1
2	M070-3003	END CAP	1
3	M070-3004	END CAP	1
4	M070-5001	SPACER	1
5	M070-6001	OUTPUT HOUSING	1
6	M070-6002	INPUT HOUSING	1
7	M070-C090	COIL- 90 VOLT	1
8	M070-R002	ROTOR	1
9	M099-9001	LABEL-MODEL#	1
10	M099-9002	LABEL-INPUT	1
11	M099-9003	LABEL-OVERLAY	1
12	YAD1-0006	3M HOT MELT	1
13	YBAB-0010	BEARING SEAL	2
14	YBAB-0011	BEARING SHIELD	2
15	YLS1-0003	GREASE SEAL	2
16	YLS2-0003	FELT SEAL	2
17	YRS1-0006	INT RET RING	2
18	YRS2-0006	EXT RET RING	4
19	YSC1-0004	SHCS 10-32 X 1/2 SS	5
20	YSC1-0015	SHCS 10-32 X 1 1/4 SS	4
21	YWS1-0010	SHIM	3
22	YWS1-0011	SHIM	1
23	YZ00-0010	SQUARE KEY	2
24	YZ00-0015	MAGNETIC POWDER	4.2 gm
25	YZ00-0021	SHRINK TUBE	1

UNLESS OTHERWISE SPECIFIED:
 DIMENSIONS ARE IN INCHES.
 ALL DIMENSIONS ARE PRE-FINISH.
 REMOVE ALL SHARP EDGES .005/.015

TOLERANCES:
 ANGULAR = ±0.5°
 TWO PLACE DECIMAL = ±0.015
 THREE PLACE DECIMAL = ±0.010

ALL MACHINED SURFACES TO BE:
 PERPENDICULAR, CONCENTRIC,
 PARALLEL WITHIN 0.005 TIR

DO NOT SCALE DRAWING

PROPRIETARY AND CONFIDENTIAL
 THE INFORMATION CONTAINED IN THIS DRAWING
 IS THE SOLE PROPERTY OF PRECISION TORQUE
 CONTROL. ANY REPRODUCTION IN PART OR AS
 A WHOLE WITHOUT THE WRITTEN PERMISSION OF
 PRECISION TORQUE CONTROL IS PROHIBITED.

	NAME	DATE
DRAWN	JHE	06-03-10
ENG APPR.	MSCOTT	06-03-10
DENSITY:	lbs/cu in	
WEIGHT:	16.040 lbs	
INERTIA:	lbs sq in	
MATERIAL		
FINISH		

PRECISION TORQUE CONTROL
Midland, MI U.S.A.

TITLE:
ASSEMBLY

SIZE	DWG. NO.	REV
B	MPC70-001	B
SCALE: 1:1	DATE OF PRINT: 7/23/2012	